

MONZA

Standard Features:

- Premium high-density, high-resiliency foam seat cushions
- Advanced unidirectional suspension system
- Double-needle top-stitch and single-needle top-stitch with thick thread
- In-arm control panel is easy to use and includes a 2-amp USB charging port
- Limited lifetime warranty on frame and suspension
- Five-year warranty on mechanism
- Three-year warranty on motor
- Quick-ship delivery

Options:

- Contrasting stitch detail available in Black, Brown, Charcoal, Cream, Espresso, Grey, Lemon, Pink, Royal, Scarlet, Tangerine, or Teal thread color
- 2-amp hour lithium-ion battery pack available
- Easy disassembly for delivery
- Metal legs available in Antique Brass, Burnished Bronze, or Polished Nickel

MNA-CH2-ST

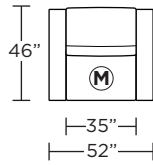

MNA-CH2-LA

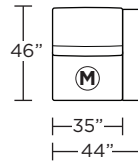

MNA-CH2-RA

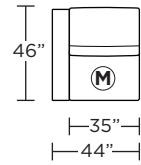

MNA-CH2-AA

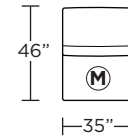

MNA-OTO-35

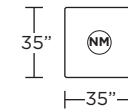

MNA-OTO-23

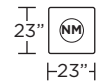

MNA-CHR-ST

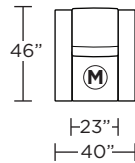

MNA-CHR-LA

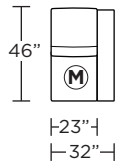

MNA-CHR-RA

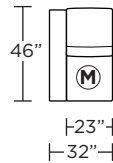

MNA-CHR-AA

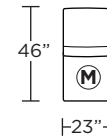

MNA-CNR-ST

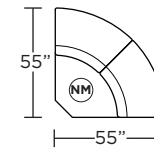

MNA-CNR-LG

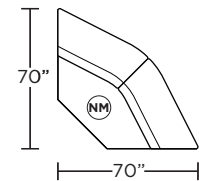

Suggested Configurations

**MNA-CH2-LA
MNA-CH2-RA**

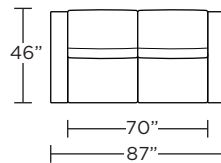

**MNA-CHR-LA
MNA-CHR-AA
MNA-CHR-RA**

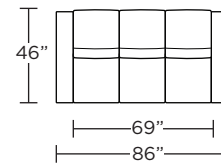

**MNA-CHR-LA
MNA-CHR-RA**

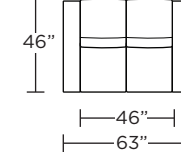

**MNA-CH2-LA
MNA-CH2-AA
MNA-CNR-ST
MNA-CH2-RA**

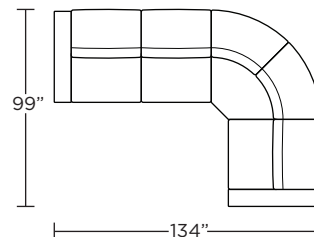

**MNA-CHR-LA
MNA-CHR-AA (3)
MNA-CNR-ST
MNA-CHR-RA**

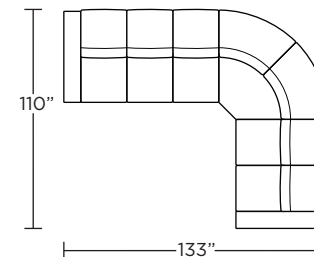

Please use actual leather, fabric, Crypton®, Sunbrella® and Ultrasuede® swatches when specifying furniture as the colors shown may vary due to the printing process.

Note: Microfiber fabrics such as SUEDELIFE and VEELIFE not suggested for this style. Please contact American Leather® Support Services for a complete list of recommended fabrics.

MOTION LEGEND:

- = Motion only
- = No motion available

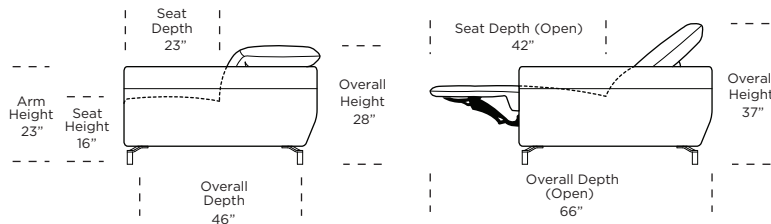

Safe low voltage electrical components are UL listed.

Scale : 1/8 inch = 1 foot
All dimensions are approximate and subject to change.
Specify all components from the sitting position.